

Frost Fighter® 2400 Test Lamp Instructions

Lamp Part No. 2400
Master Kit Part No 2700

www.frostfighter.com

The **Frost Fighter Test Lamp Kit** is an inexpensive way to test automotive rear window defrosters and identify broken defroster lines. Less expensive than a Multimeter, the test lamp kit uses a 12 volt lamp with two long leads attached and marking tape. By moving the leads over the defroster and watching the lamp its easy to verify defroster is working and to locate those small hard to find breaks.

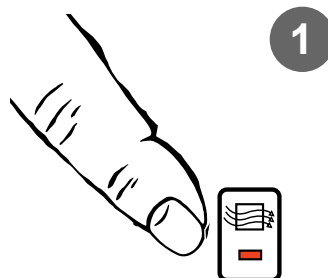

1 Turn on rear defroster

Turn on the defroster. Some defrosters require that the vehicle be running to function. If this is the case be sure the vehicle is in park with the parking brake on and the area is well ventilated.

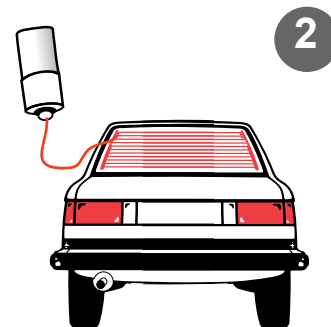

2 Connect red lead to metal defroster clip

Working inside the vehicle clip the test lamp's red lead to the defrosters metal clip located on the vehicles LEFT side. This is normally the positive side of the circuit. If the defroster clip is covered just touch the red lead to the defrosters main power bar.

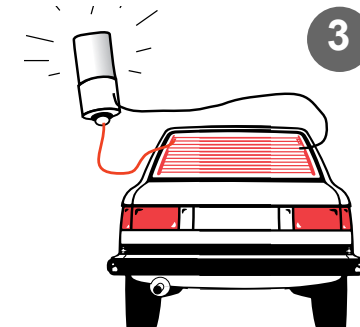

3 Test defroster to determine if it's main circuit is working

Place the test lamps black wire lead on the right power tab's metal base. The test lamp should glow brightly. If the lamp does not glow at all then the defroster circuit is faulty and should be checked for shorts, blown fuse or damaged relay.

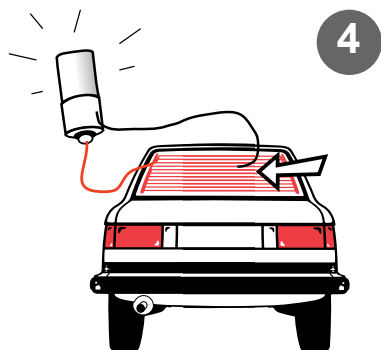

4 Move the black lead along the grid

Move the point of the test lamps black lead along the top defroster line toward the red lead touching the thin horizontal defroster line approximately every three inches. Be very careful not to scratch the defroster with the test lead. Try tin foil on the lead. Check each defroster line individually.

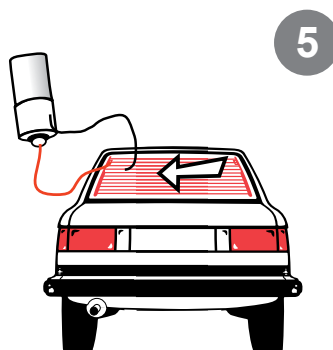

5 Watch the lamp for signs of a break in the defroster

On most vehicles you will notice that the lamp gets slightly dimmer at each point until within 3-6 inches of the right power tab when the lamp will not light at all. This is normal. Even the slightest glow from the lamp indicates the defroster line is working. Now reverse the red & black wires and test again.

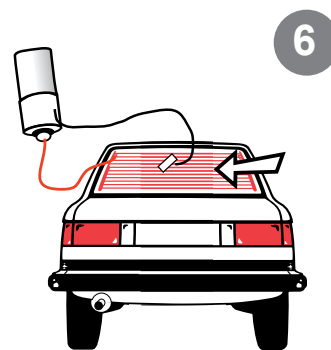

6 Find the defroster breaks and mark them

If you encounter a break in the defroster grid you will see the lamp go out as you pass over it. By testing using increasingly small intervals the damaged area can be accurately located. Mark the damaged area with tape. Repair damaged defroster grids with the **2100 Frost Fighter Grid Repair Kit**.

Warranty and Disclaimer:

Since the Seller cannot control the manner or use of its products after their sale, Seller will not be responsible for any consequential or indirect damages. There are no express warranties which extend beyond the description on the face hereof. Seller disclaims any implied warranties of merchantability or fitness for any particular purpose. The Seller will, at its option, either replace the products sold or refund the purchase. No warranties will apply if the products are in any way altered or modified after delivery by Seller.

Frost Fighter™ is a trademark of
Planned Products
© 1998-2004 Planned Products
MADE AND PRINTED IN USA

Troubleshooting Tips
www.frostfighter.com